



DO YOU KNOW IF YOUR SMOKE ALARM IS WORKING ?



- On November 4, 2007 change your clock.
- Find your smoke alarm.
- Test your smoke alarm.
- Practice with your entire family including your pets.
- Change the smoke alarm battery and test the battery to make sure it is working.
- **Smoke and toxic gases kill more people than flames do.**

Throughout the United States, someone dies in a fire every 162 minutes. Four out of every five deaths occur in homes, Many of those homes **did not** have a good working smoke alarm in or they never took the time to install a smoke alarm.

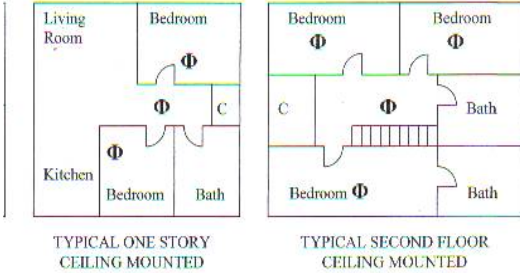

Installing smoke alarms at the proper level will provide you with the earliest warning possible. Always follow the manufacturer's installation instructions.

Φ SMOKE DETECTOR

In the event of a fire, a **smoke alarm** can save your life and those of your loved ones. They are a very important means of preventing fire fatalities by providing an early warning signal – that means you and your family have a better chance of escaping.

Los Angeles City requires that there is at least one **smoke alarm** in each **sleeping area** and in the hall leading to the room.

- Smoke alarm shall be installed at a point centrally located on the wall or ceiling, in every sleeping room and in each hallway, corridor, or adjacent area to such sleeping room.
- Where sleeping rooms are on an upper level, an alarm shall be placed at the center of the ceiling directly above the stairway.
- The top of any smoke alarm installed on a wall shall be no closer than **4 inches or farther then 12 inches** from the ceiling.
- In bachelor or efficiency units,(single sleeping room) one smoke alarm shall be centrally mounted on the ceiling or wall.



If you have a vision or hearing problem, you should get a special alarm.

Fire Marshal Jimmy Hill says all it takes is one smoke alarm in your house to save your entire family, know what they sound like, and practice.

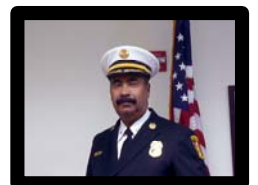

Jimmy H. Hill
Fire Marshal

Upon request, the LAFD will provide reasonable accommodations to ensure equal access to its programs, services, and facilities.

For more information, please visit your local fire station or go to: www.lafd.org